

# Darien High School Cross Country Track

Darien Athletic Foundation

Darien, Connecticut

September 4, 2014

MARK	DATE	DESCRIPTION
3	12/23/2015	REVISED
2	12/15/2015	REVISED
1	11/02/2015	REVISED
PROJECT NO: D-0247		
FILE: XCOUNTRY3.dwg		
DRAWN BY: MDS		
CHECKED: JAC		
APPROVED: JWS		

**SCHEMATIC PLAN**

SCALE: 1" = 100'

**XC1.00**

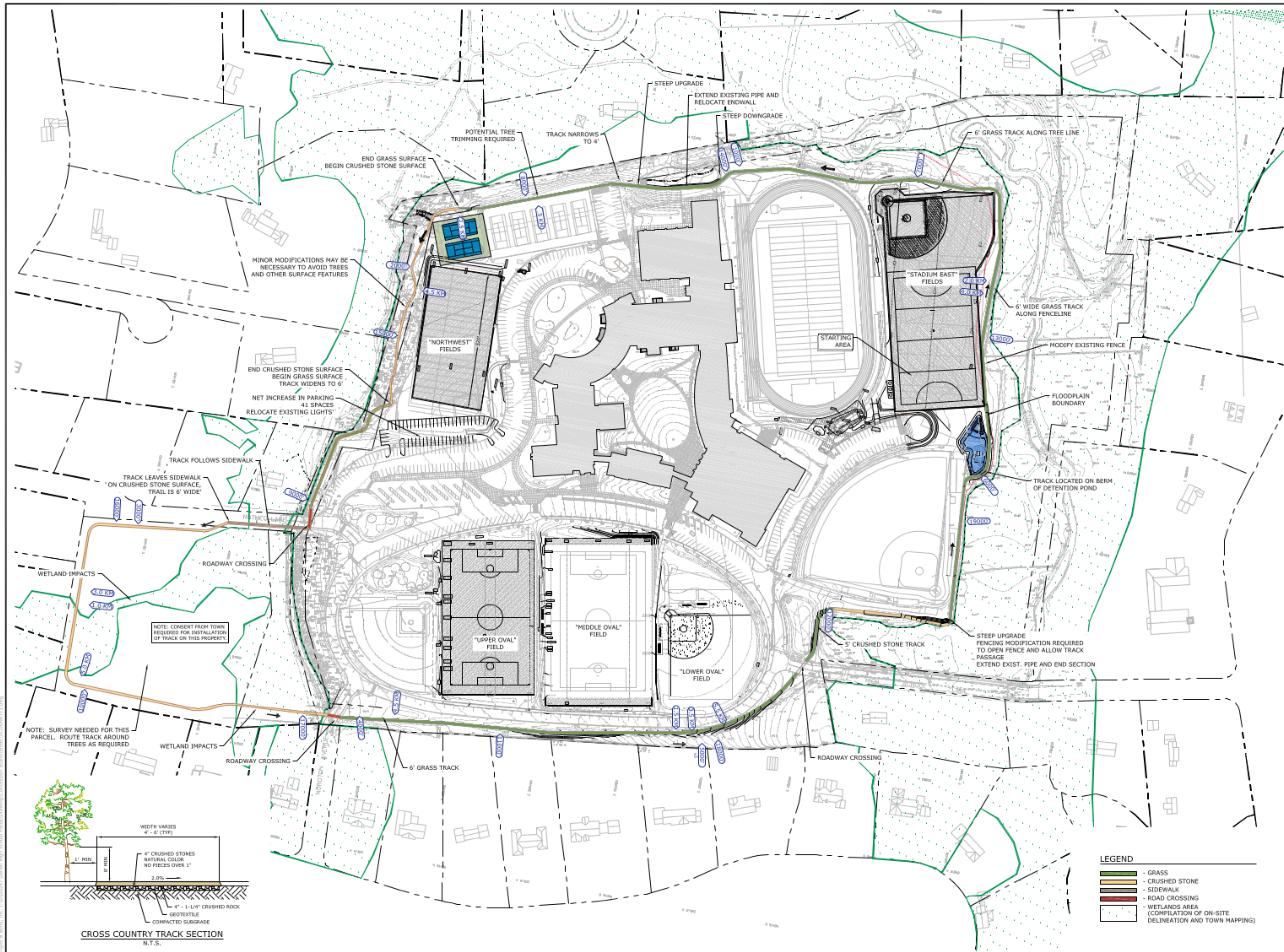

MINOR MODIFICATIONS MAY BE NECESSARY TO AVOID TREES AND OTHER SURFACE FEATURES

END CRUSHED STONE SURFACE BEGIN GRASS SURFACE, TRACK WIDENS TO 6'  
NET INCREASE IN PARKING 41 SPACES RELOCATE EXISTING LIGHTS

TRACK LEAVES SIDEWALK ON CRUSHED STONE SURFACE, TRAIL IS 6' WIDE

NOTE: CONSENT FROM TOWN REQUIRED FOR INSTALLATION OF TRACK ON THIS PROPERTY.

NOTE: SURVEY NEEDED FOR THIS PARCEL. ROUTE TRACK AROUND TREES AS REQUIRED

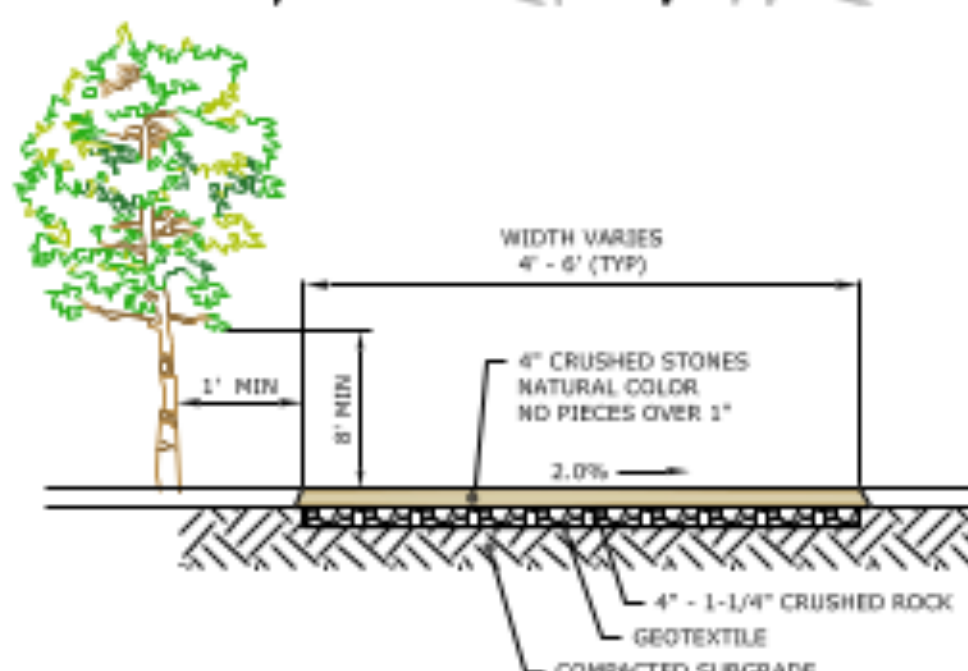

**CROSS COUNTRY TRACK SECTION**  
N.T.S.

**LEGEND**

- GRASS
- CRUSHED STONE
- SIDEWALK
- ROAD CROSSING
- WETLANDS AREA (COMPILATION OF ON-SITE DELINEATION AND TOWN MAPPING)

Date: 2/15/2015 10:30:00 AM Project: Darien High School Fieldhouse/Concession Stand/SheetXCOUNTRY3.dwg  
Tighe & Bond, Inc. 1/10/2014 10:30:00 AM